

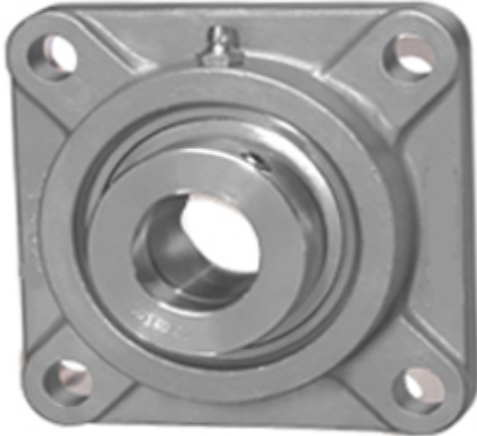

IPTCI SNASF 210 32 Flange Block Bearings



Bearing No. SNASF 210 32

SNASF 210 32 Bearing 2D drawings and 3D CAD models

Category	Flange Block Bearings
Inventory	0.0
Manufacturer Name	IPTCI BEARINGS
Minimum Buy Quantity	N/A
Weight	2.857
Product Group	M06110
Number of Mounting Holes	4
Mounting Method	Eccentric Collar
Housing Style	4 Bolt Square Flange Block
Rolling Element	Ball Bearing
Housing Material	Stainless Steel
Expansion / Non-expansion	Non-expansion
Mounting Bolts	9/16 Inch
Relubricatable	Yes
Insert Part Number	SNA210-32
Seals	B Seal
Housing Configuration	1 Piece Solid
Pilot Configuration	No Pilot
Inch - Metric	Inch
Long Description	4 Bolt Square Flange Block; 2" Bore; 6.2" Bolt Circle; 4-3/8" Bolt Spacing; 1 Piece Solid; Eccentric Collar Mount; Stainless Steel; Ball Bearing; 2.248" Length Thru Bore; Relubrica
Other Features	Single Row Corrosion Resistant Stainless Steel Insert Has Slinger



Shanghai Burken Trading Co., Ltd.

Category	Flange Block
UNSPSC	31171501
Harmonized Tariff Code	8483.20.40.40
Noun	Bearing
Keyword String	Flanged
Manufacturer URL	http://www.iptci.com
Manufacturer Item Number	SNASF 210 32
Weight / LBS	6.3
Nominal Bolt Circle Diameter Round	6.2 Inch 157 Millimeter
Cartridge Pilot Depth	0 Inch 0 Millimeter
D	2.248 Inch 57.1 Millimeter
d	2 Inch 50.8 Millimeter
Bolt Spacing	4.375 Inch 111.13 Millimeter
Cartridge Pilot Diameter	0 Inch 0 Millimeter